

0.78± Acre Homesite

Burnett Drive

Rankin County, MS



\$40,000

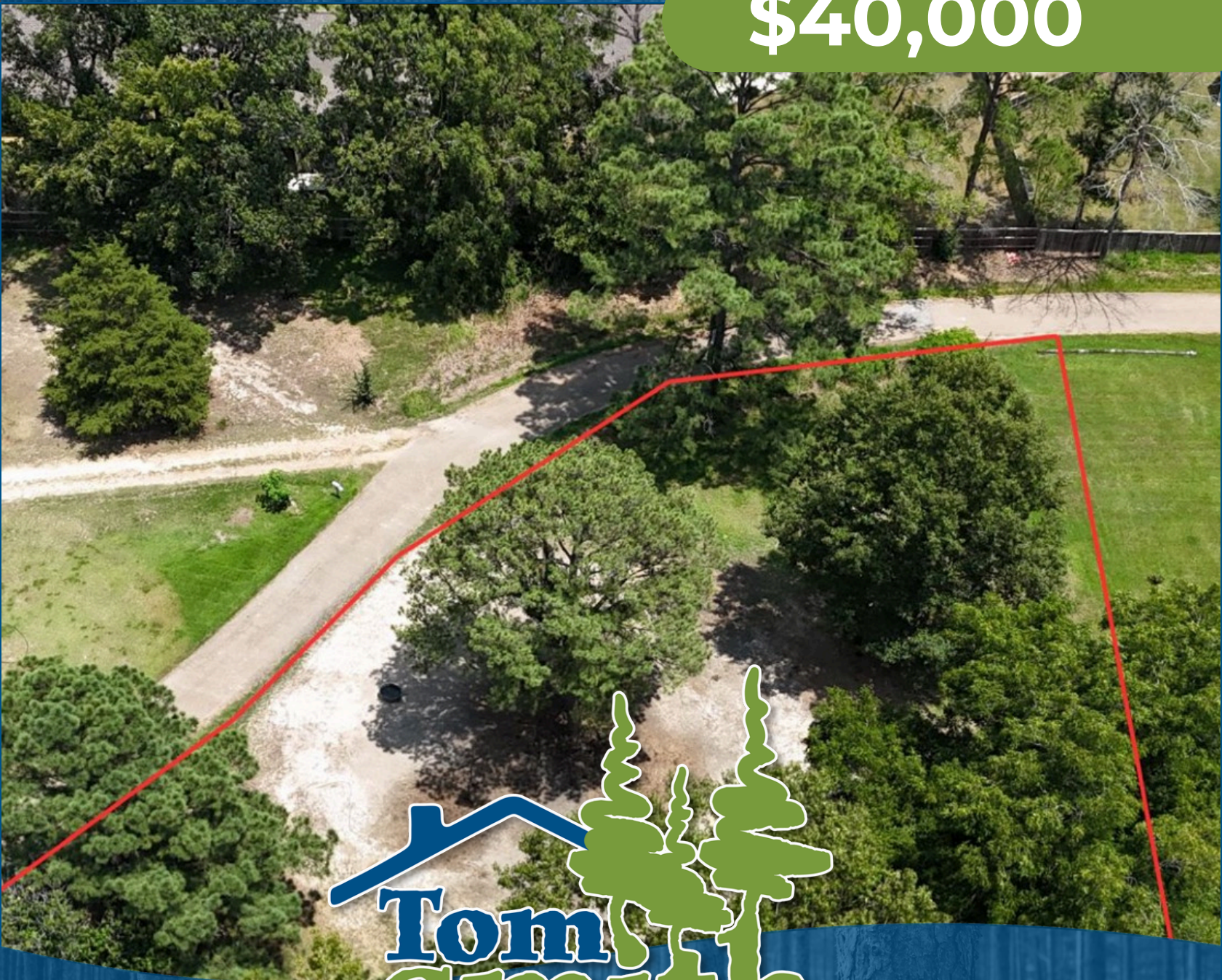

Expect More. Get More.

TomSmithLandandHomes.com

Office: 601.898.2772

Property Information

Location:

- Rankin County, MS

Property Use:

- Homesite

Coordinates:

- 32.40802, -90.00425

Property Highlights

- 0.78± Acres
- Power and Water Available
- Minutes from Ross Barnett Reservoir
- 370 Ft of Paved Road Frontage



Expect More. Get More.

**A Real Estate Expert
You Can Trust!**

**KADERO
EDLEY**

REALTOR®

Office: 601.898.2772

Cell: 601.488.7000

Kadero@TomSmithLand.com

The Property

0.78± Acres

Have you been looking for a new home site by the Rez? Look no further than this .78± acre lot in Rankin County, MS! Just minutes from the Ross Barnett Reservoir, this is an ideal location to have your dream home and enjoy some fun on the water with your family. There is roughly 370 ft. of paved road frontage on Burnett Drive, and utilities are available. If you've been searching for a new homesite, call Kadero Edley to schedule your private viewing!



**KADERO
EDLEY**
REALTOR®

Office: 601.898.2772
Cell: 601.488.7000

Kadero@TomSmithLand.com



Expect More. Get More.

Aerial Map

[VIEW INTERACTIVE MAP](#)



**KADERO
EDLEY**
REALTOR®

Office: 601.898.2772
Cell: 601.488.7000

Kadero@TomSmithLand.com



Expect More. Get More.

Ownership Map

[VIEW INTERACTIVE MAP](#)

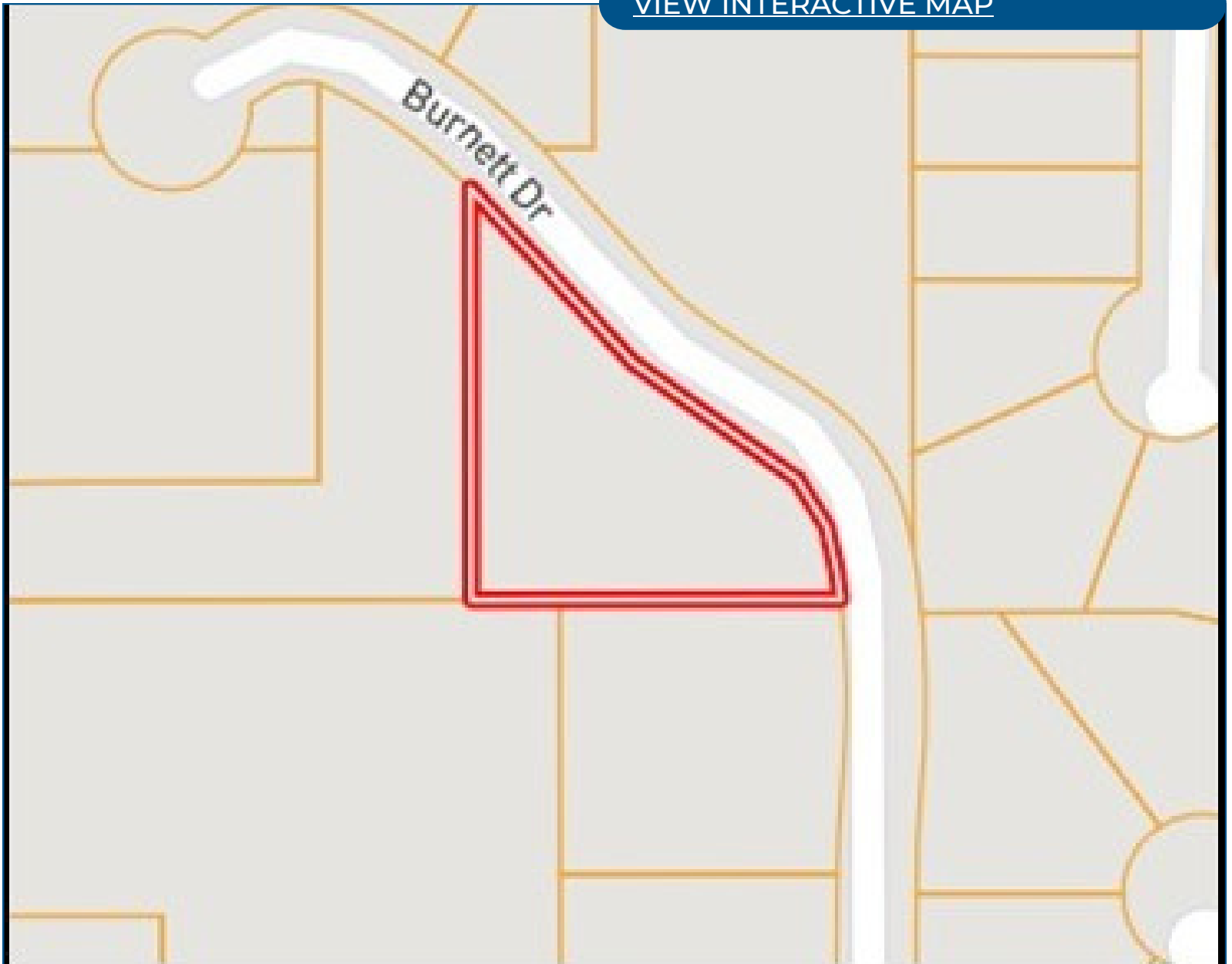

**KADERO
EDLEY**

REALTOR®

Office: 601.898.2772

Cell: 601.488.7000

Kadero@TomSmithLand.com



Expect More. Get More.

Directional Map

[VIEW INTERACTIVE MAP](#)

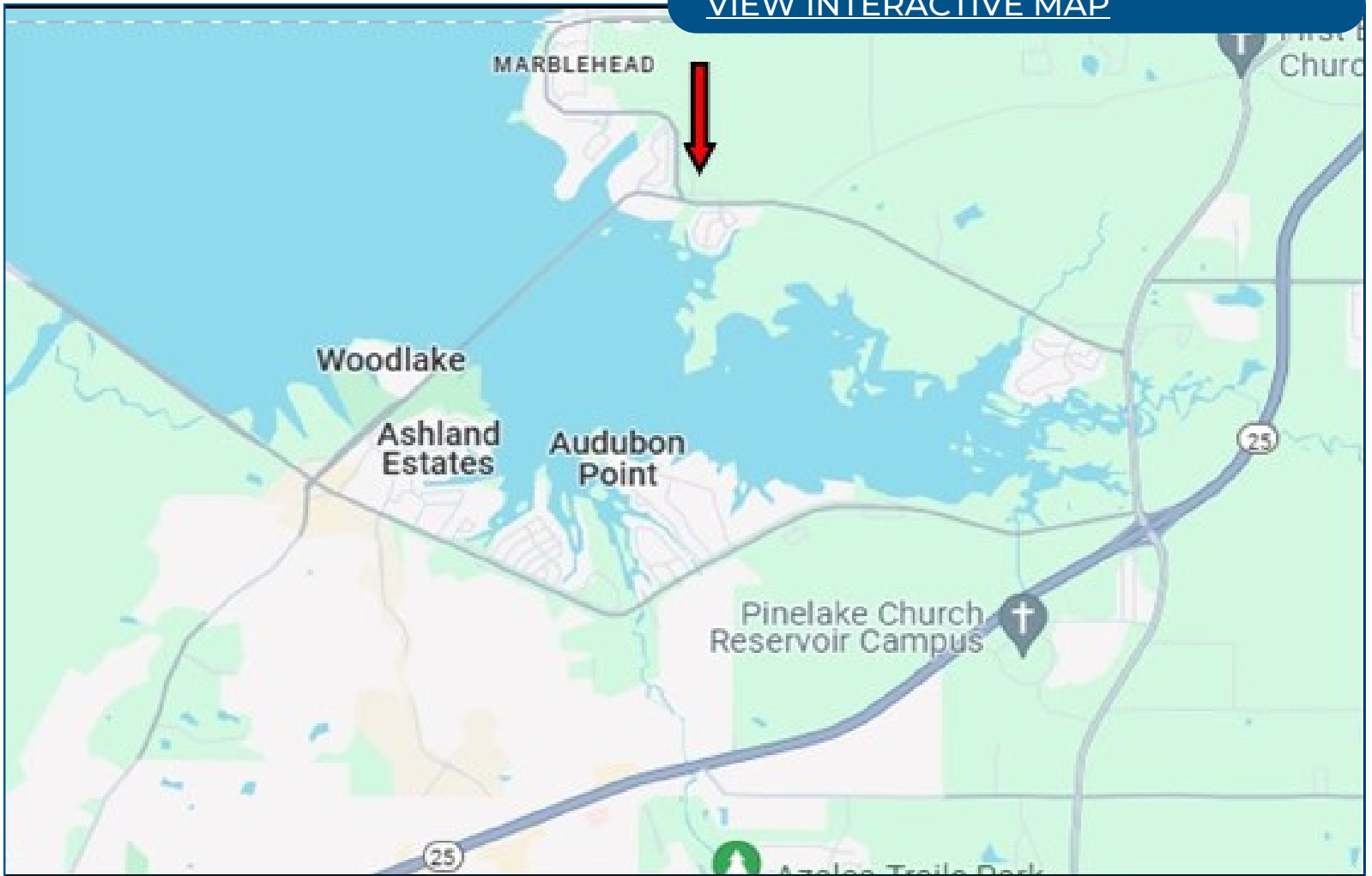

Directions from Hwy 25 and Hwy 471 in Brandon, MS (39047): Take the exit for Hwy 471 towards Brandon. Turn onto Hwy 471 N and travel 1 mile. Turn left onto N Shore Pkwy and travel 2.4 miles. Turn right onto McCoy Trail and travel 312 ft. Turn right onto Burnett Drive. After 0.2 miles, the property will be on your left

**KADERO
EDLEY**
REALTOR®

Office: 601.898.2772
Cell: 601.488.7000

Kadero@TomSmithLand.com

